

AQUA-BASE[®]

watermakers

by SLCE

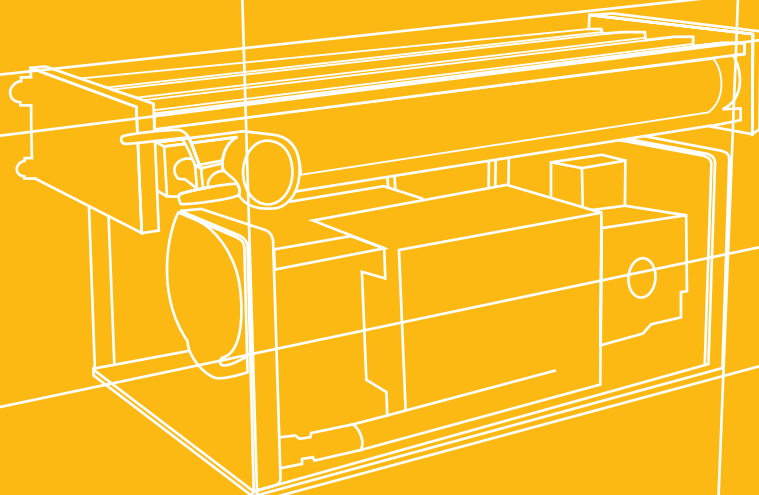

From 30 to 300 litres per hour

Aqua-Base[®]X

from 30
to 90 L/h

Yachting

Very compact watermakers specifically designed for small boats where available energy and space are limited.

Specifications

- Battery powered or generator
- Low pressure seawater feed pump
- High pressure CAT pump
- High rejection rate membranes
- 5 Micron filter
- High pressure safety switch
- Pressure regulation valve
- High pressure gauges
- Salinometer and automatic diversion valve



Options

- Remote control
- Automatic flushing
- Separation kit

X

X in a frame

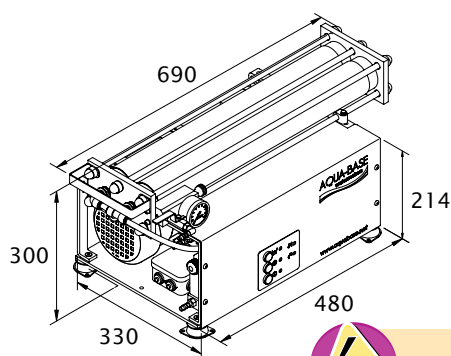

X

X with separation option

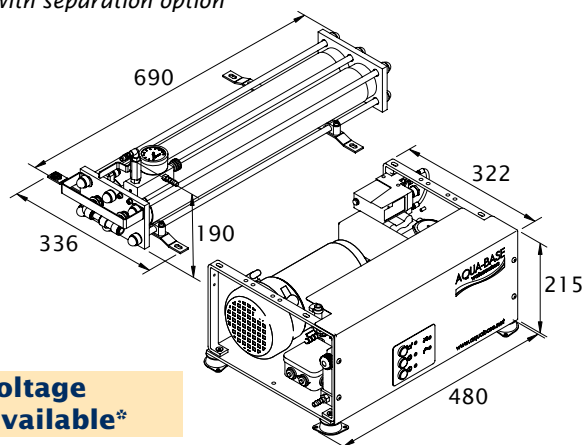

**Dual voltage
models available***

Capacity	Model	Voltage			Electricity Consumption	Weight
		Battery	Single phase	Three phase		
30 L/h	XD121*	12 V	-	-	31 A	34 kg
	XD241*	24 V	-	-	25 A	36 kg
	XA221	-	230 or 115 V	-	1 kW	38 kg
50 L/h	XD122*	12 V	-	-	31 A	40 kg
60 L/h	XD242*	24 V	-	-	25 A	42 kg
	XA222	-	230 or 115 V	-	1 kW	44 kg
90 L/h	XA223	-	230 or 115 V	-	1 kW	50 kg

Rated performances +/- 10% using standard seawater, with 35 g/l salinity and temperature at 25°C.

*Dual voltage models available : 12/230V or 24V/230V.

Very simple to install and use, AQUA-BASE® watermakers are delivered complete with an installation kit and detailed instructions.
 All AQUA-BASE® watermakers are certified by Bureau Veritas.



Aqua-Base®Y

from 60
to 300 L/h

Yacht
Charter
Professional
Boat

Heavy-duty design watermakers recommended for intensive users.



Specifications

- Tri-phase or single phase electricity feed
- Low pressure seawater feed pump
- High pressure CAT pump
- High rejection rate membranes
- 5 & 20 Micron filters
- High and low pressure safety switches
- Pressure regulation valve
- High and low pressure gauges
- Salinometer and automatic diversion valve
- Hour meter
- Flow meter

Options

- Remote control
- Automatic flushing
- Sand filter

YC

Y in a frame

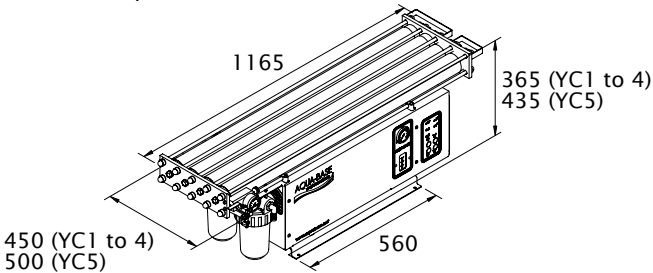

YK

Y in kit form

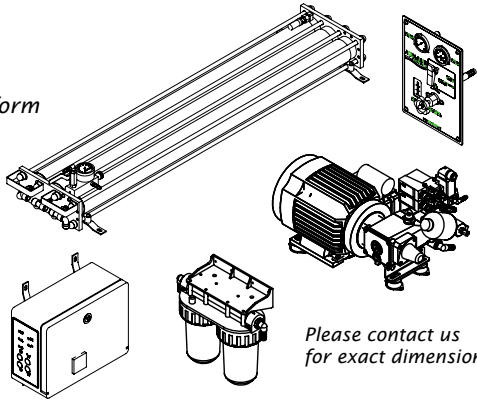

Please contact us for exact dimensions

Capacity	Model	Voltage			Electricity Consumption	Weight
		Battery	Single phase	Three phase		
60 L/h	YC1	-	230 or 115 V	400 ou 220 V	1,5 kW	61 kg
	YK1	-				52 kg
120 L/h	YC2	-	230 or 115 V	400 ou 220 V	1,5 kW	69 kg
	YK2	-				60 kg
180 L/h	YC3	-	230 or 115 V	400 ou 220 V	2 kW	77 kg
	YK3	-				68 kg
240 L/h	YC4	-	230 or 115 V	400 ou 220 V	2 kW	85 kg
	YK4	-				76 kg
300 L/h	YC5	-	230 V	400 ou 220 V	3 kW	95 kg
	YK5	-				86 kg

Rated performances +/- 10% using standard seawater, with 35 g/l salinity and temperature at 25°C. Other voltages on request.



Aqua-Base®Eco

from 35
to 105 L/h

Low
energy
consumption

Energy recovery watermakers designed for boats
where energy available is very limited.



ESB/ESW

35 et 65 L/h

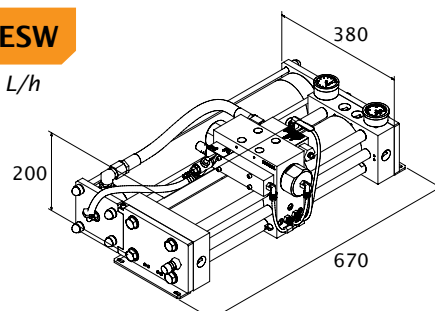

**Only 12 Amps at 12 Volts
to produce 35 litres/hour**

Two versions are available :
- **ESB** : Basic manual version.
- **ESW** : Automatic version,
includes automatic salinity control.

Specifications

- Low-pressure seawater feed pump
- Desalination module
- 5 Micron filter

Options

- Remote control (ESW)
- Automatic flushing (ESW)
- Dual voltage

ESW

105 L/h

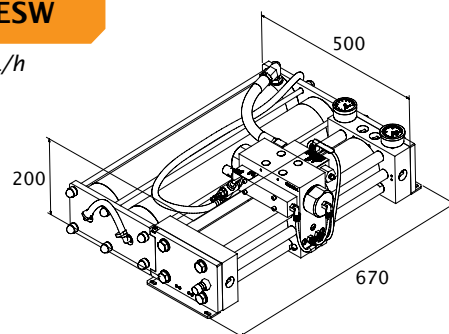

**Dual voltage
models available***

Capacity	Model	Voltage		Electricity Consumption	Weight
		Battery	Single phase		
35 L/h	ESB/ESW301*	12 V	-	12 A	41 kg
	ESB/ESW302*	24 V	-	6 A	41 kg
65 L/h	ESB/ESW601*	12 V	-	25 A	49 kg
	ESB/ESW602*	24 V	-	12,5 A	49 kg
105 L/h	ESW901*	12 V	-	34 A	63 kg
	ESW902*	24 V	-	17 A	63 kg

Rated performances +/- 10% using standard seawater, with 35 g/l salinity and temperature at 25°C.

*Dual voltage models available : 12/230V or 24V/230V.

Aqua-Base® reliability and service

AQUA-BASE® offers two technologies for the desalination of sea water :

- Our standard technology range, using a high pressure pump, with capacities from 30 L/h to 300 L/h.
- Our ECO range, with energy recovery technology, with capacities from 35 L/h to 105 L/h.

Designed and built by SLCE, the AQUA-BASE® range is complete, simple and reliable. AQUA-BASE® only uses the finest quality materials and components in its manufacturing processes.

AQUA-BASE® machines are subject to rigorous and lengthy testing, carried out on a permanent basis by SLCE's Quality Assurance Service. Some assembly-line machines undergo intense trials, which can last for more than 10,000 hours. This testing qualifies AQUA-BASE® for "Bureau Veritas" certification.

Naturally, AQUA-BASE® benefits from SLCE's world-wide sales and technical assistance service.

AQUA-BASE® Standard Technology models

- Compact machines supplied either in a frame or in kit form for fitting into any situation,
- Everything required is supplied as standard, with automatic salinity control of the produced water, and an installation kit,
- Simple and easy to use control panel,
- Excellent accessibility for simple and easy maintenance.

AQUA-BASE® Energy Recovery (ECO) Models

The concept

The traditional high-pressure pump, the main energy user, is replaced by a hydraulic amplifier system fed by a low pressure pump. This patented technology is applied by SLCE to the AQUA-BASE ECO range: it is simple and economical.

Advantages

- **Very low energy consumption:** only 12 A at 12 volts to produce 35 L/h
- **Remarkably quiet:** less than 64 dbA at 1m distance
- **Total absence of vibration**
- **Simple to use:** no need to adjust pressures. Entirely hydraulically operated, the machine is automatically self-regulating according to operating conditions
- **Very easy installation:** on the floor, on a wall, on a ceiling, vertically or horizontally
- **Simplified maintenance:** no need to change pump oil
- **Optimised membrane life** by always operating in ideal conditions: SLCE's endurance testing shows that its lifespan exceeds 10, 000 hours

Optional extras:

- **Remote control:** integrates the unit's command and control functions
- **Automatic rinsing:** allows Fresh water rinsing of the membranes
- **Sand filter:** available on the Y range, improves pre-filtration and prolongs the life of the pre-filters
- **Dual voltage (DC and AC):** available on the ECO and XD ranges, allows alternative electricity supply, either generator or battery

AQUA-BASE[®]

watermakers

149 rue Salvador Dali
ZA de Kergouaran - Caudan
CS 8002
56607 LANESTER Cedex
France

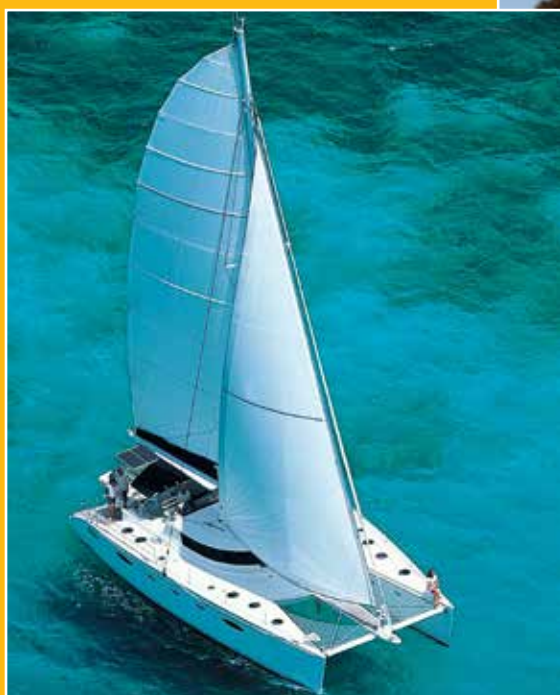

tel. [+33\(0\)297 838 888](tel:+330297838888)

fax [+33\(0\)297 838 333](tel:+330297838333)

e-mail slce@slce.net

internet www.aquabase.net



Your contact

AQUA-BASE[®] is a trademark of SLCE